

BFW

Hydraulic Flange Elbow
DIN Flange / Metric Flareless

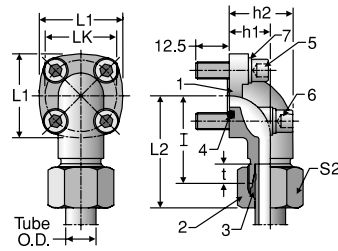

Visual Index

How To Order

Specs

Assembly / Installation

Reference Section

TUBE FITTING PART #	WORKING PRESSURE (bar)	END SIZE (mm)	h1 (mm)	h1 (mm)	l (mm)	L1 (mm)	L2 (mm)	LK (mm)	S2 (mm)	t (mm)	STANDARD MATERIAL FROM STOCK		STANDARD EO-2 FROM STOCK	
											A3C	71	A3C	71
BFW15L/LK40A3C	65	15	22.5	36.5	38	42	46	40	27	7	•		•	
BFW18L/LK40A3C	65	18	22.5	36.5	38	42	47	40	32	7.5	•		•	
BFW22L/LK40A3C	65	22	22.5	36.5	38	42	47.5	40	36	7.5	•		•	
BFW28L/LK40A3C	65	28	28	43	40	42	49	40	41	7.5	•		•	
BFW35L/LK40A3C	65	35	32	55	41	42	52	40	50	10.5	•		•	
BFW35L/LK55A3C	65	35	32	51.5	49	58	62	55	50	10.5	•		•	
BFW42L/LK55A3C	65	42	40	64.5	49	58	61	55	60	11	•		•	
BFW15L/LK35A3C	155	15	16.5	26.5	38	39	46	35	27	7	•		•	
BFW20S/LK55A3C	155	20	24	38	45	58	56	55	36	10.5	•		•	
BFW20S/LK40A3C	155	20	22.5	35.5	40	42	50	40	36	10.5	•		•	
BFW25S/LK55A3C	155	25	30	46	49	58	61	55	46	12	•		•	
BFW30S/LK55A3C	155	30	32	50	49	58	62	55	50	13.5	•		•	
BFW10L/LK35A3C	200	10	16.5	26.5	38	39	47	35	19	7	•		•	
BFW12L/LK35A3C	200	12	16.5	26.5	38	39	47	35	22	7	•		•	
BFW16S/LK35A3C	200	16	20	31	38	39	48	35	30	8.5	•		•	

Unassembled BFW Fitting Components

1 Elbow Body	2 Nut	3 Progressive Ring	4 O-Ring	5 2 Cap Screws DIN 912-8.8	6 2 Cap Screws DIN 912-8.8	7 4 Spr. Washers DIN 127
BFW15L/LK40A3CX	M15LA3CX	DPR15LA3CX	OR26X2.5X	M6X22	M6X22	A6
BFW18L/LK40A3CX	M18LA3CX	DPR18LA3CX	OR26X2.5X	M6X22	M6X22	A6
BFW22L/LK40A3CX	M22LA3CX	DPR22LA3CX	OR26X2.5X	M6X22	M6X22	A6
BFW28L/LK40A3CX	M28LA3CX	DPR28LA3CX	OR26X2.5X	M6X20	M6X50	A6
BFW35L/LK40A3CX	M35LA3CX	DPR35LA3CX	OR26X2.5X	M6X22	M6X60	A6
BFW35L/LK55A3CX	M35LA3CX	DPR35LA3CX	OR33X2.5X	M8X25	M8X60	A8
BFW42L/LK55A3CX	M42LA3CX	DPR42LA3CX	OR33X2.5X	M8X25	M8X70	A8
BFW15L/LK35A3CX	M15LA3CX	DPR15LA3CX	OR20X2.5X	M6X22	M6X35	A6
BFW20S/LK55A3CX	M20SA3CX	DPR20SA3CX	OR33X2.5X	M8X25	M8X50	A8
BFW20S/LK40A3CX	M20SA3CX	DPR20SA3CX	OR26X2.5X	M6X22	M6X45	A6
BFW25S/LK55A3CX	M25SA3CX	DPR25SA3CX	OR33X2.5X	M8X25	M8X55	A8
BFW30S/LK55A3CX	M30SA3CX	DPR20SA3CX	OR33X2.5X	M8X25	M8X55	A8
BFW10L/LK35A3CX	M10LA3CX	DRP10LA3CX	OR20X2.5X	M6X22	M6X35	A6
BFW12L/LK35A3CX	M12LA3CX	DPR12LA3CX	OR20X2.5X	M6X22	M6X35	A6
BFW16S/LK35A3CX	M16SA3CX	DPR16SA3CX	OR20X2.5X	M6X22	M6X40	A6
BFW20S/LK35A3CX	M20SA3CX	DPR20SA3CX	OR20X2.5X	M6X22	M6X45	A6

EO-2 Part Number example: BFW15ZL/LK40A3C

Temperature range without pressure reductions for fittings with O-ring sealing of NBR (e.g., buna N series) -35°C up to +100°C, FPM (e.g., fluorocarbon on request) -25°C up to +120°C.

Tightening torques for socket head cap screws see [Table T6](#).

Dimensions and pressures for reference only, subject to change.